



## Pembridge Gardens, W2

£560 per week (£2,426 pcm)



- One Bedroom
- Natural Light
- Excellent Condition
- Wooden Floors
- Lift-Access
- Prime Location

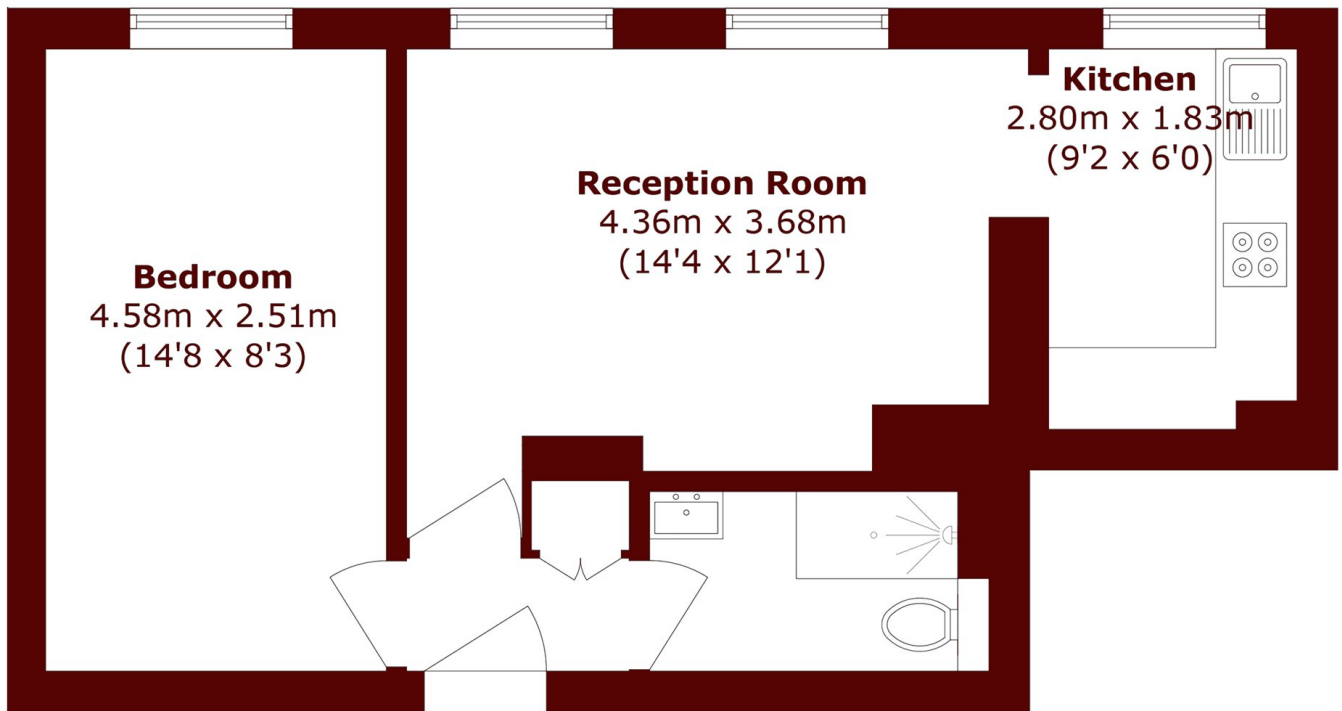

## Fourth Floor

Total area (approx.): 36.9 sq. m (397.1 sq. ft)

### Marsh & Parsons Notting Hill

2-6 Kensington Park Road,  
London, W11 3BU  
020 7313 2890