



## Fountain Road, SW17

£485,000

2 1 1 C

- Two Bedrooms
- Ground Floor Maisonette

- Private Garden
- Off Street Parking

- Close to Transport Links
- 606 Sq. Ft.







## ABOUT THE PROPERTY

A well maintained two bedroom maisonette set in a Victorian property, with a neatly landscaped garden located in Tooting Broadway.

This lovely two bedroom property is located on the ground floor, and offers good proportions, high ceilings and wooden flooring throughout. The reception room is located towards the front of the property and benefits from large sash style windows. The master bedroom follows, along with a smaller second bedroom. Towards the back of the property is a kitchen/dining room with a fully fitted kitchen utilising the corner space of the room. A unique feature of this property is the separate utility room. Completing this maisonette is the neatly landscaped, partially paved private garden.



Fountain road is perfectly located within walking distance to Tooting Broadway. Local amenities are in abundance and access into and out of the city are frequently provided by both Tooting Broadway (Northern line, zone 3) and bus routes.



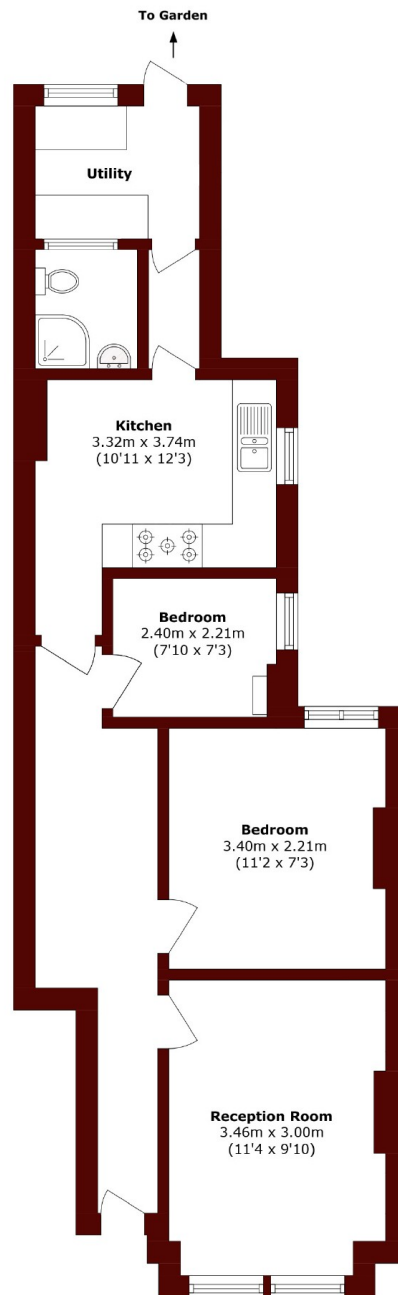

Total area (approx.): 56.3 sq. m (606.0 sq. ft)

**Marsh & Parsons Tooting**  
29-31 Upper Tooting Road,  
London, SW17 7TS  
020 8767 3655

We aim to make our particulars both accurate and reliable. However, they are not guaranteed; nor do they form part of an offer or contract. If you require clarification on any points then please contact us, especially if you're traveling some distance to view. Please note that appliances and heating systems have not been tested and therefore no warranties can be given as to their good working order.