



## Byton Road, SW17

£750,000

2 1 2 D

- End of Terrace House
- Two Double Bedrooms
- Landscaped Private Garden
- 844 Sq. Ft.
- Great Transport Links
- Modern Interior







## ABOUT THE PROPERTY

A beautiful end of terrace property with a brick facade, modern interior and private garden.

Offering a stunning blend of period charm and contemporary living, this property comes to the market in pristine condition. The ground floor has been designed as the perfect living space with an open plan reception and dining area, separated slightly by a cased opening. Both rooms have built-in storage and from the dining room you can access the neatly landscaped private garden complete with its own ornamental pond. The separate, fully fitted kitchen features a tasteful splash of colour and benefits from an abundance of natural light. Two double bedrooms can be found on the first floor, both very spacious, alongside the modern family bathroom. There is opportunity for a loft and side return extension (STPP).



Byton Road is a charming residential road located in Tooting Broadway where a plethora of amenities, bars and restaurants are located. Excellent schools are also located nearby (Tooting Primary and Graveney School). Local bus routes are frequent along with Tooting Broadway Tube Station (Northern Line, zone 3) just 0.5m away, and Tooting Thameslink station is a mere 0.2m away.



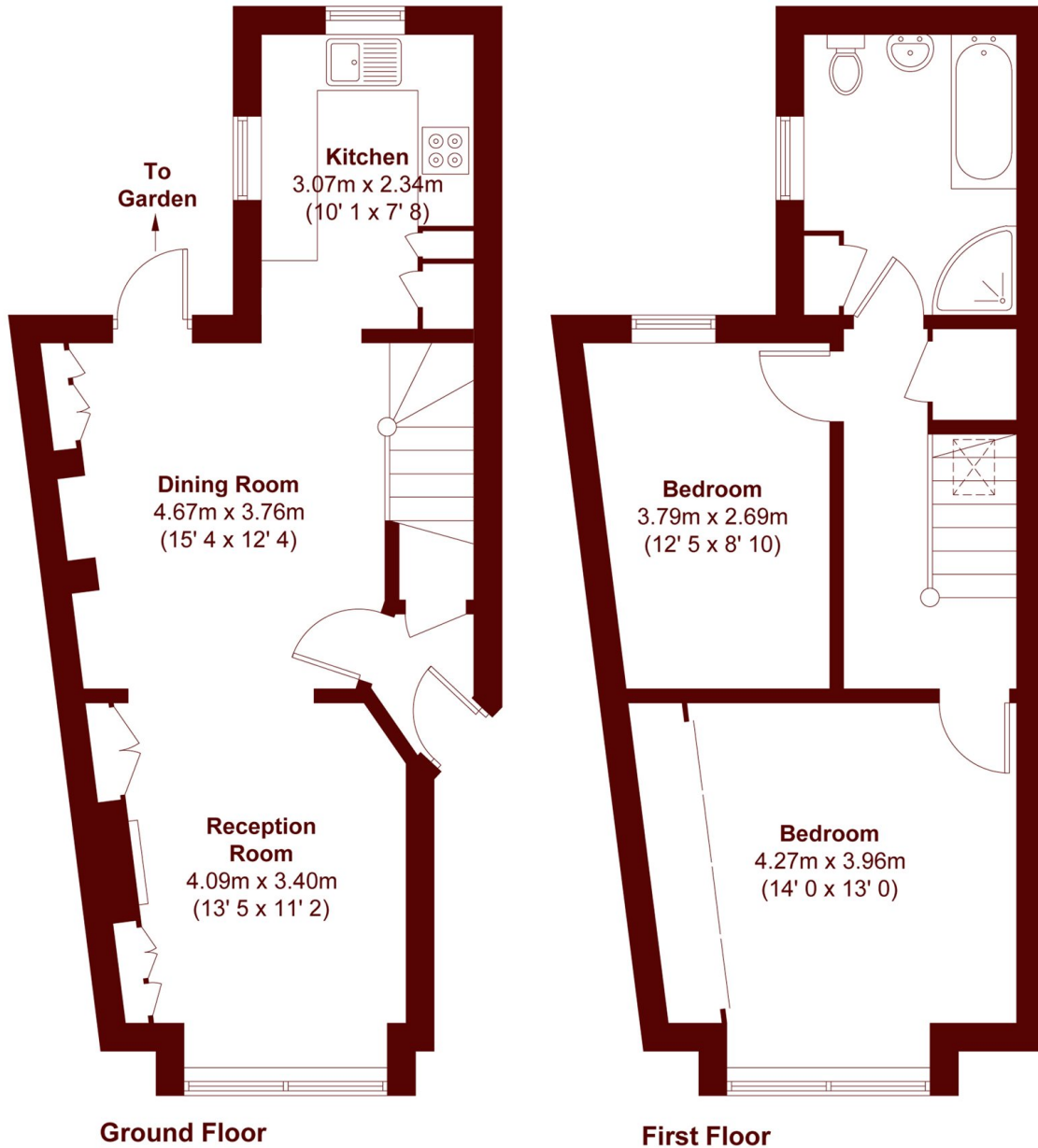

APPROX. GROSS INTERNAL FLOOR AREA  
844 SQFT / 78.4 SQM

**Marsh & Parsons Tooting**  
29-31 Upper Tooting Road,  
London, SW17 7TS  
020 8767 3655

We aim to make our particulars both accurate and reliable. However, they are not guaranteed; nor do they form part of an offer or contract. If you require clarification on any points then please contact us, especially if you're traveling some distance to view. Please note that appliances and heating systems have not been tested and therefore no warranties can be given as to their good working order.

[marshandparsons.co.uk](http://marshandparsons.co.uk)