



Stapleton Road, SW17

£650,000



- Three Double Bedrooms
- Close to Transport Links

- Doorstep of Tooting Common
- Private Garden

- Ground Floor Flat
- 815 Sq. Ft.





ABOUT THE PROPERTY

A neat and well maintained ground floor flat set in a beautiful red brick building, perfectly located for access to transport and Tooting Bec Common.

Offering three bedrooms, this property is perfect for a family or first time buyers. Two double bedrooms are located towards the front of the property, both benefitting from large windows and high ceilings offering a bright and spacious feel. The reception room benefits from neat wooden flooring and leads to the separate, fully fitted kitchen where there is direct access to the private garden south westerly facing garden. Completing the property is a third double bedroom and a family bathroom with a shower over the bath.



Stapleton Road is a charming residential road that can be found moments from Tooting Bec Common. Local bus routes as well as Tooting Bec Station (Northern Line, Zone 3) are within walking distance which both allow easy access into and out of the City.



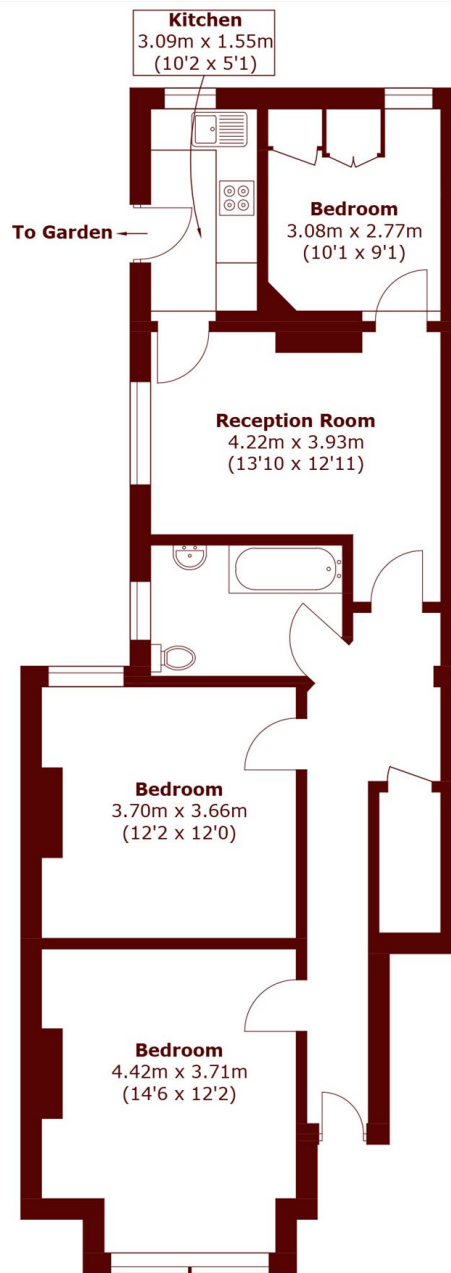

Total area (approx.): 75.7 sq. m (814.8 sq. ft)

Marsh & Parsons Tooting
29-31 Upper Tooting Road,
London, SW17 7TS
020 8767 3655

We aim to make our particulars both accurate and reliable. However, they are not guaranteed; nor do they form part of an offer or contract. If you require clarification on any points then please contact us, especially if you're traveling some distance to view. Please note that appliances and heating systems have not been tested and therefore no warranties can be given as to their good working order.