



## Inglemere Road, CR4

£435,000



- Ground Floor
- Maisonette

- Two Bedrooms
- Close to Transport Links

- Private Garden
- 548 Sq. Ft.









## ABOUT THE PROPERTY

A bright and modern two bedroom, ground floor maisonette with a spacious private garden.

This ground floor maisonette set in a late Victorian conversion comes to the market in pristine condition. Two bedrooms are located towards the front of the property, both of which have built-in wardrobes and high ceilings. There is potential to use one room as study as it is currently set up, or a nursery. There is a contemporary family bathroom with a shower over the bath and wooden flooring which continues through to the reception room. A cased opening doorway provides partial separation between the living room and fully fitted kitchen. Completing this property is the neat private garden, with partial paving as well as horizontal slatted fencing for privacy, and built-in seating.



Inglemere Road is a quiet residential road situated close to a plethora of local amenities, and local bus routes. Tooting Overground (Thameslink) is within walking distance, providing easy access into and out of the City. The property is well located for Tooting Common and Tooting Broadway Market, offering an excellent selection of leisure, dining and recreational options.



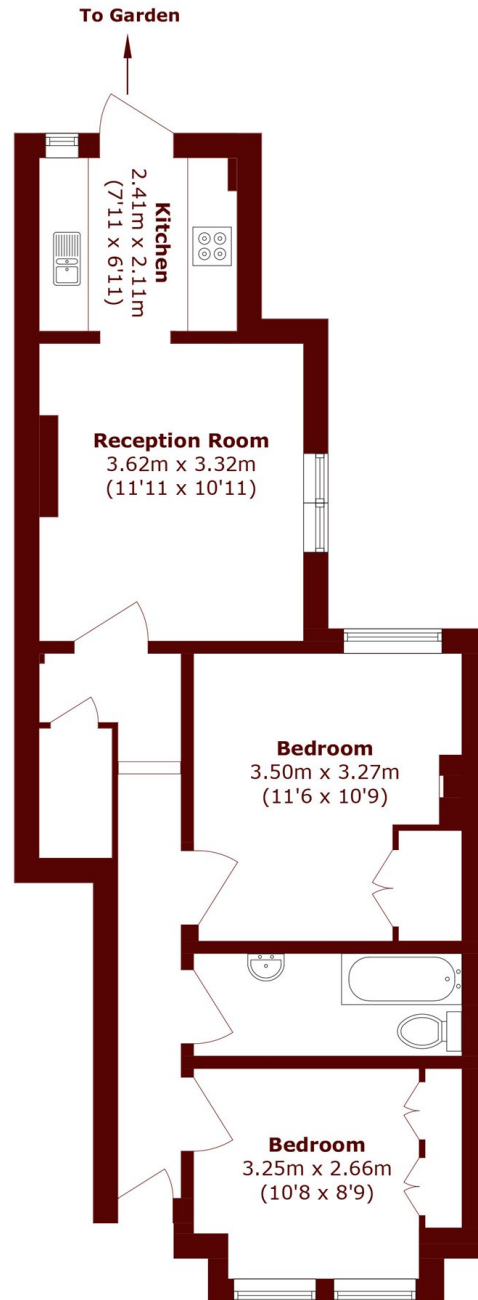

Total area (approx.): 50.9 sq. m (547.6 sq. ft)

**Marsh & Parsons Tooting**  
29-31 Upper Tooting Road,  
London, SW17 7TS  
020 8767 3655

We aim to make our particulars both accurate and reliable. However, they are not guaranteed; nor do they form part of an offer or contract. If you require clarification on any points then please contact us, especially if you're traveling some distance to view. Please note that appliances and heating systems have not been tested and therefore no warranties can be given as to their good working order.