



Trevelyan Road, SW17

£530,000

 2  1  1  D

- Share of Freehold
- Two Bedrooms

- Ground Floor Maisonette
- Private Garden

- Great Location
- 698 Sq. Ft.





ABOUT THE PROPERTY

A bright, two bedroom maisonette located on the ground floor of a gorgeous red brick property in Tooting Broadway.

This delightful property boasts period features throughout, and offers generous proportions spanning just shy of 700 sq. Ft. Upon entering you are greeted by a beautiful front living room with two large casement windows, allowing light to flood the interior, and a feature fireplace. The spacious master bedroom follows before passing the second bedroom and entering the charming eat-in kitchen. The generous bathroom with both a bath and a separate shower is located to the rear of the property. Completing this property is a neatly paved private garden.



Trevelyan Road is a beautiful tree lined road located within walking distance of all local amenities, bars and restaurants on both London road as well as Mitcham Road. Tooting Overground, as well as Tooting Broadway (Northern line, Zone 3) are also within easy reach, allowing frequent access into and out of the City.

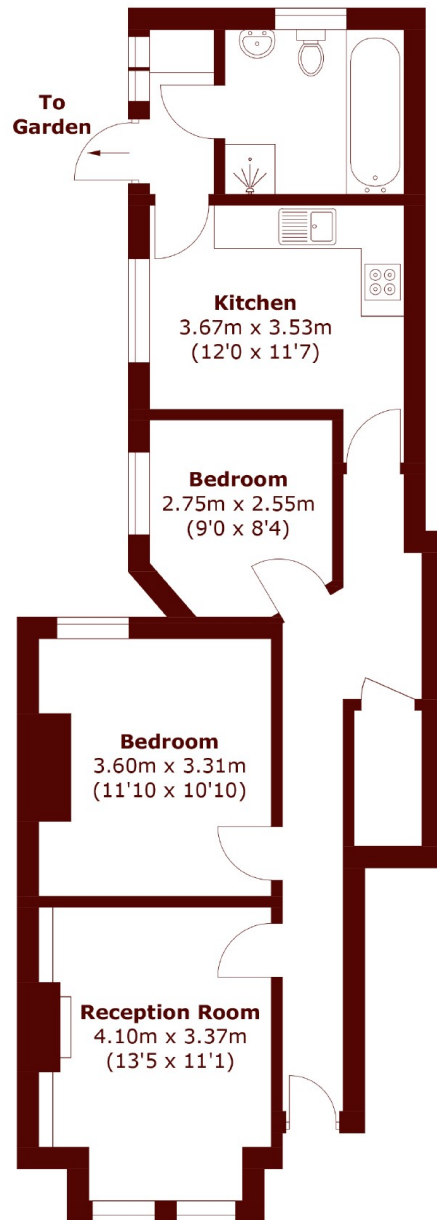

Total area (approx.): 64.8 sq. m (697.5 sq. ft)

Marsh & Parsons Tooting
29-31 Upper Tooting Road,
London, SW17 7TS
020 8767 3655

We aim to make our particulars both accurate and reliable. However, they are not guaranteed; nor do they form part of an offer or contract. If you require clarification on any points then please contact us, especially if you're traveling some distance to view. Please note that appliances and heating systems have not been tested and therefore no warranties can be given as to their good working order.