



Richmond Road, SW20

£325,000

 1  1  1  E

- One Double Bedroom
- Top Floor
- Communal Gardens
- Convenient location
- Offered Chain Free
- Share Of Freehold





ABOUT THE PROPERTY

This charming one-bed flat is situated on the top floor of a sought after mansion development. With a large naturally bright reception, separate fitted kitchen and bathroom/wc this would make an ideal purchase for a first-time buyer. Sold with no onward chain and share of freehold.

The location is ultra-convenient within easy reach of Raynes Park mainline station providing frequent rail links to Waterloo via Clapham Junction and close to the shops, bars and restaurants of Coombe Lane.



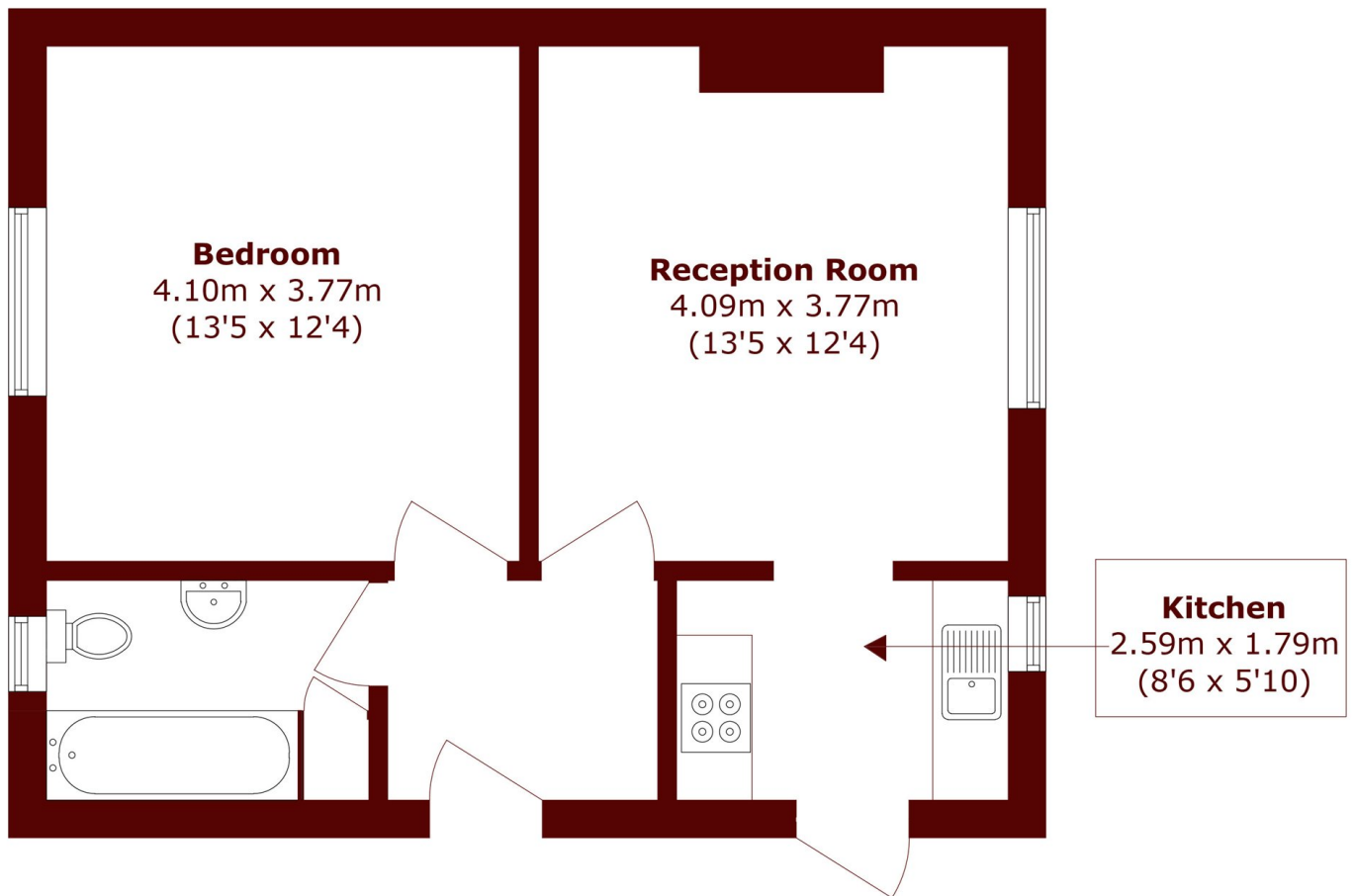

Total area (approx.): 45.9 sq. m (494.0 sq. ft)

Marsh & Parsons Wimbledon

24 High Street, Wimbledon
Village, SW19 5DX
020 8879 6660